



Pressure, Level & Temperature Transmitters & Transducers

2770 Long Road, Grand Island, NY 14072 USA

Tel. (716) 773-9300 • Fax (716) 773-5019

sales@gp50.com • www.gp50.com

PLUG-ON DISPLAY WITH ONE RELAY

Model LD1001



Seen here with GP:50's
Model 311 pressure transmitter

FEATURES:

- 3 1/2 digits with one relay
- Available as part of GP:50's Quick Ship program

INPUT:

- 4-20 mA

SUPPLY:

- 4-20 mA transmitter

INTERFACE:

- DIN 43650 interface (GP:50 connector option 'CJ')

APPLICATION:

The LD1001 plug-on display is a universal local display with an adjustable set point, suitable for use with any GP:50 4-20mA 2 wire transmitter. Removing the front cover of the display will reveal 2 programming buttons. These are used to input the desired settings for the following parameters: zero, scale, decimal point position, damping & switching point.

LD1001 is factory set up when ordered with a transmitter for easy field installation.

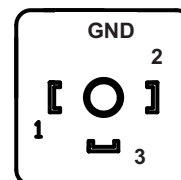
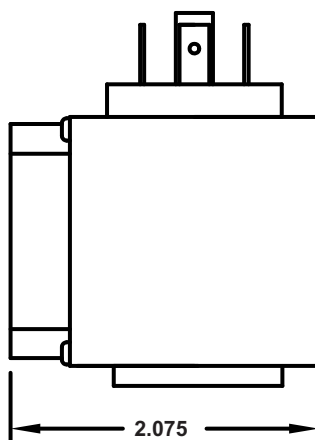
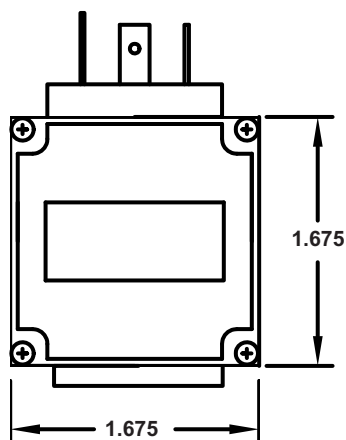

A5SL-LD1001.00