

## SINGLE-ENDED SHEAR BEAM

**65023A-5507**

Alloy Steel, NTEP Certified 1:5000 Class III Multiple Cell, IP67

**Dimensions***Picture is a representation of actual product*

Rated Capacity	A1	A3	B	C	D	E	F	G
<b>lb/in</b>								
1,000-2,500	1/2-20 UNF-2B	0.53	1.25	0.75	5.12	1.00	3.00	0.50
<b>kg/mm</b>								
453.6-1,134.0	1/2-20 UNF-2B	13.5	31.8	19.05	130.1	25.4	76.2	12.7

**Order Information**

Load Rating		Part#	Est. Weight	Price
1,000 lb	453.6 kg	<b>107785</b>	3 lb	Consult
2,500 lb	1,134.0 kg	<b>107786</b>	3 lb	Consult

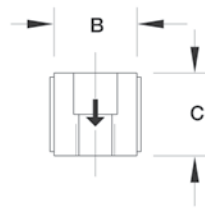
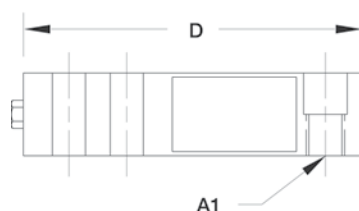
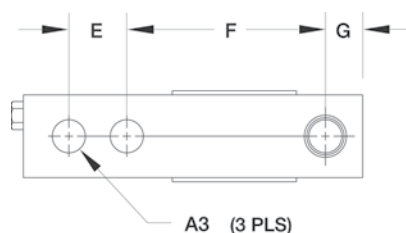
**Specifications****Full Scale Output:**

3.0 mV/V

**Output Resistance:**

349-355 ohms

**Input Resistance:**

343-357 ohms

**Material/Finish:**

High-alloy steel, nickel plated

**Temperature:**Compensated range  
14° F to 104° F (-10° C to 40° C)Operating range  
-40° F to 150° F (-40° C to 65° C)**Safe Overload:**

150% full scale

**Safe Sideload:**

100% full scale

**Rated Excitation:**

5-10 VDC (15 VDC max)

**Nonlinearity:**

0.03% full scale

**Hysteresis:**

0.02% full scale

**Combined Error:**

0.02% full scale

**Insulation Resistance:**

5,000 megohms

**Deflection at Capacity:**1,000 lb=0.013 in (0.33 mm),  
2,500 lb=0.015 in (0.38 mm)**Seal Type:**

Environmentally sealed, IP67

**Cable Length:**

10 ft (3.05 m)

**Cable Diameter:**

0.200 polyurethane jacket

**Cable Color Code:**

Red .....+ Excitation  
 Black.....- Excitation  
 Green .....+ Signal  
 White .....- Signal

**Warranty:**

One-year limited warranty

**Approvals:**