

Miniature Flush Transmitter

Pressure - Level - Temperature Products

Follow Us: [in](#) [f](#) [t](#) [+](#)

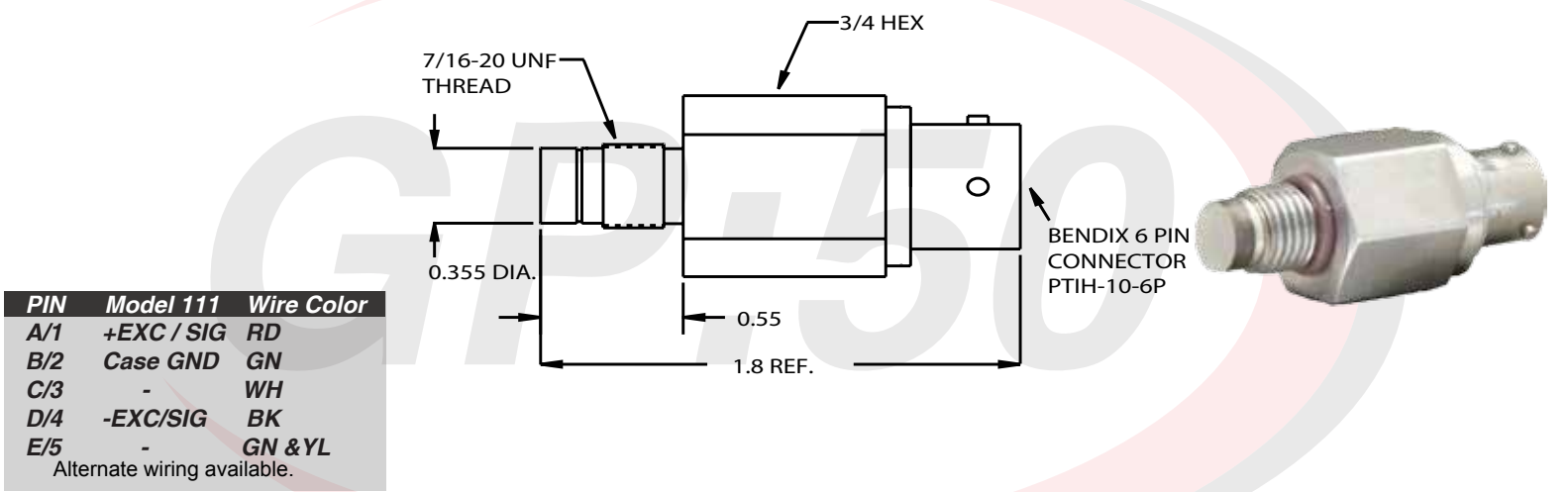

PIN	Model 111	Wire Color
A/1	+EXC / SIG	RD
B/2	Case GND	GN
C/3	-	WH
D/4	-EXC/SIG	BK
E/5	-	GN & YL

Alternate wiring available.

Model / 188

Features

- Rugged, SST construction
- Designed to withstand pressure spikes
- Optional process and electrical connections
- mV/V option shown, VDC & 4-20mA output options available.
- Temperature output option

Field Options

The "88" series offers a compact, flush faced design in a mV/V, VDC or 4-20mA output option. Optional process and electrical connections are available as well as different wetted materials to withstand corrosive media. Thermocouple or RTD temperature output option available.

Applications

- Adhesive dispensing
- Paint Systems
- Slurry or sludge pressures
- Brake Pressure & Temperature

Small but Tough

The '88' series was designed to fit in tight spaces but handle pressures up to 10,000 PSI. It's one piece, all welded SST flush sensor design offers high performance in a rugged package. The flush port eliminates any dead volume and great for adhesives, slurries or other media that clogs standard process connections.

Proven Record

GP:50 has over 25 years of field experience with a strong aerospace heritage. We provide some of the most accurate, reliable pressure transducers on the market. GP:50 provides products rated from sub-sea to deep space, designed for your specific needs. With over 25 years of market experience we have the ability to provide products that can perform in some of the toughest environments.

GP:50 reserves the right to make product improvements and amendments to the product specifications stated throughout this brochure without prior notification. Please contact the factory on all critical dimensions and specifications for verification.

Miniature Flush Transmitter

Pressure - Level - Temperature Products

Follow Us: [in](#) [f](#) [t](#) [+](#)

Model /188

Electrical

- Supply Voltage: 5-15 VDC
- Output Signal: 1 to 3 mV/V (Range Dependant)
- Zero Balance: +/-1% FSO
- Output: mV/V: +/-1% FSO
- Input Resistance: 5,000 ohms (350 ohm option)
- Connection: PTIH-10-6P (Other options available)
- Frequency Response: ~3 kHz

Material of Construction

- Wetted Parts: 17-4 PH SST

Static Accuracy

- Includes Hysteresis, repeatability and non-linearity: +/-0.5%FSO (improved available)

Mechanical

- Process Connection: SAE-4 Male w/O-ring
- Proof Pressure: 1.5X (20,000 PSI max)
- Burst Pressure: 5X (22,500 PSI Max)

Pressure Ranges

- 0-500 thru 0-15,000 PSI

Thermal Specifications

- Compensated: 70-170 deg F (other options available to 375 deg F)
- Operating: -65 to +375 deg F
- Zero Effect: +/-1%FSO/100 deg F
- Span Effect: +/-1%FSO/100 deg F

Formats

- Sealed Gage & Absolute

Options

- Improved thermal effect to +/-0.5%/100 deg F
- Improved accuracy to +/-0.15% FSO (May effect output)
- High Temperature Operation:
To 375 deg F Continuous, 400 deg F intermittent
- RTD output: 100 or 1000 ohm platinum, 2, 3 or 4 wire
- Thermocouple Output: J or K Type
- Shunt Calibration

Options available, consult factory

GP:50 reserves the right to make product improvements and amendments to the product specifications stated throughout this brochure without prior notification. Please contact the factory on all critical dimensions and specifications for verification.